



STUD HOLE DESIGNATION TRUCK WHEELS

ES 3.15

Page 1/4

DESIGNATION DES FIXATIONS DE ROUES DE CAMION
VERSENKBEZEICHNUNGEN FÜR NUTZFAHRZEUGGRÄDER

1 - SCOPE AND FIELD OF APPLICATION

This Euwa specification covers the dimensions of stud holes for truck wheels and the definition of a code to be used as marking on the wheels.

2 - STUD HOLE CODE

M	22					Plain Stud Hole
M B	22	I E D	S C	24 60		Spherical / Conical Stud Hole

M hub centring
 B bolt centring

diameter / angle
 spherical / conical
 inside / external / double side
 stud diameter

Marking the stud hole type on the disc is not compulsory. As far as possible, and especially contingent on agreement of truck makers, this code should be used for any kind of marking of new wheels.

3 - DIMENSIONS AND TOLERANCES

Dimensions and tolerances of the different types of stud holes listed in the following tables are mainly in accordance with ISO 4107. All deviations are indicated.

Main changes compared to the last issue:

No part of this standard may be reproduced in any form without the prior written permission of EUWA

3.1 - PLAIN STUD HOLES

Plain stud holes only can be used in combination with hub centring.

Special diameters **d** are marked with "/" followed by divergent diameter.

Designation	Diameter d +1 / -0
M 18	21
M 20	24
M 22	26
M 22/32	32 *)
M 22/33	33 *)

*) only for alloy wheels with special nuts.

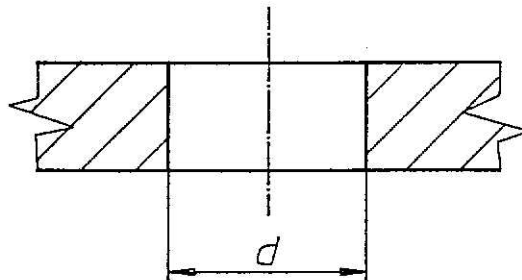

3.2 - SPHERICAL STUD HOLES

To make it possible to integrate types of stud holes which differ slightly from ISO 4107, the diameter tolerances of stud hole and countersink are enlarged against ISO 4107.

All stud holes for thread diameter 22 are also usable for thread diameter 20 without any changes.

Designation	Diameter d_2 +1 / -0	Diameter d_3 +0.5 / -0.5	Radius r_1 +0.1 / -0.1
M 14ES 28 M14ES28 M 14DS28 B 14IS28 B 14 E S 28 B 14 D S 28	18.5	24	14
M 18I S 32 M 18 E S 32 M 18D S 32 B 18 I S 32 B 18 E S 32 B 18 D S 32	21.5	27	16
M 22 I S 36 M 22 E S 36 M 22 D S 36 B 22 I S 36 B 22 E S 36 B 22 D S 36	26	32	18
M 14 D S 28 M 19 D S 44.4	20.5 32.5	25 37.5	14 *) 22.2 *)

*) not recommended for new design

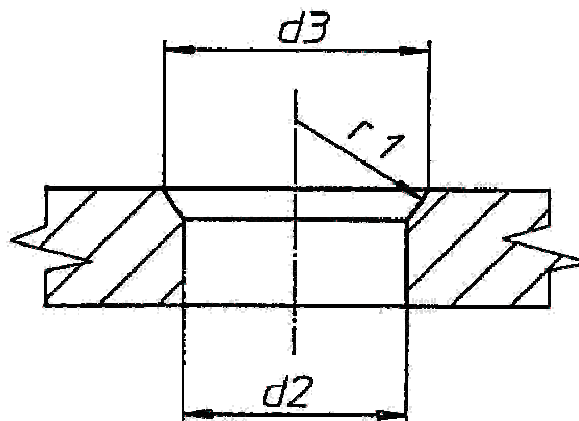

3.3 - CONICAL STUD HOLES

Conical stud holes are not recommended for new design.

To make it possible to integrate types of stud holes which differ slightly from ISO 4107, the diameter tolerances of stud hole and countersink are enlarged against ISO 4107.

Designation	Diameter d_2 +1 / -1	Diameter d_3 +0.5 / -0.5	Angle α° +1° / -1°
M 23 I C 80	26	31	80°
M 23 E C 80			
M 23 D C 80			
B 23 I C 80			
B 23 E C 80			
B 23 D C 80			

